

Ordnance Survey (c) Crown Copyright 2016. All rights reserved. Licence number 100022432

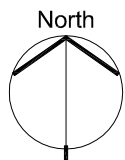
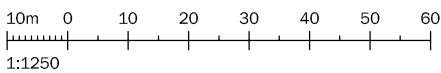

revisions: _____

<p>Roger Adcock Architectural Design Ltd.</p> <p>Sycamore House, The Street, Fritton, Norwich, Norfolk, NR15 2QT. T: 01508 218248 M: 07747 000343 E: rogeradcock@btinternet.com</p> <p>Company No. 09570140 Registered in England & Wales. Registered office: King Street House, 15 Upper King Street, Norwich, NR3 1RB.</p>	client:	One Planning Consultants.
	project:	Land at Bell Meadow, Low Road, Wortwell, Norfolk, IP20 0HJ.
	drawing:	Location Plan.
	scale @ A4:	1:1250.
	drawing number:	1610 - 02

Copyright: this drawing must not be re-issued, loaned or copied without the consent of the above. Do not scale this drawing.

Title Number : NK299284

This title is dealt with by Land Registry, Kingston upon Hull Office.

The following extract contains information taken from the register of the above title number. A full copy of the register accompanies this document and you should read that in order to be sure that these brief details are complete.

Neither this extract nor the full copy is an 'Official Copy' of the register. An official copy of the register is admissible in evidence in a court to the same extent as the original. A person is entitled to be indemnified by the registrar if he or she suffers loss by reason of a mistake in an official copy.

This extract shows information current on 31 MAY 2016 at 14:37:43 and so does not take account of any application made after that time even if pending in the Land Registry when this extract was issued.

REGISTER EXTRACT

Title Number	: NK299284
Address of Property	: land at Wortwell
Price Stated	: Not Available
Registered Owner(s)	: JOHN CHARLES RICHES of 1 Mill Lane, Ellingham, Bungay, Suffolk NR35 2PX TERESA DEBORAH RICHES of 1 Mill Lane, Ellingham, Bungay, Suffolk NR35 2PX.
Lender(s)	: None

Title number NK299284

This is a copy of the register of the title number set out immediately below, showing the entries in the register on 31 MAY 2016 at 14:37:43. This copy does not take account of any application made after that time even if still pending in the Land Registry when this copy was issued.

This copy is not an 'Official Copy' of the register. An official copy of the register is admissible in evidence in a court to the same extent as the original. A person is entitled to be indemnified by the registrar if he or she suffers loss by reason of a mistake in an official copy. If you want to obtain an official copy, the Land Registry web site explains how to do this.

A: Property Register

This register describes the land and estate comprised in the title.

NORFOLK : SOUTH NORFOLK

- 1 (03.10.2003) The Freehold land shown edged with red on the plan of the above title filed at the Registry and being land at Wortwell.

B: Proprietorship Register

This register specifies the class of title and identifies the owner. It contains any entries that affect the right of disposal.

Title absolute

- 1 (03.10.2003) PROPRIETOR: JOHN CHARLES RICHES of 1 Mill Lane, Ellingham, Bungay, Suffolk NR35 2PX and TERESA DEBORAH RICHES of 1 Mill Lane, Ellingham, Bungay, Suffolk NR35 2PX.
- 2 (03.10.2003) The value stated as at 19 September 2003 was £72,500.

End of register

LR

NORFOLK ; SOUTH NORFOLK

ORDNANCE SURVEY MAP REFERENCE

TWENTY

SCALE 1:2500

© CROWN COPYRIGHT. Reproduced by permission of the Controller of Her Majesty's Stationery Office. All rights reserved. No part of this publication may be reproduced without the prior written permission of the Controller of Her Majesty's Stationery Office.

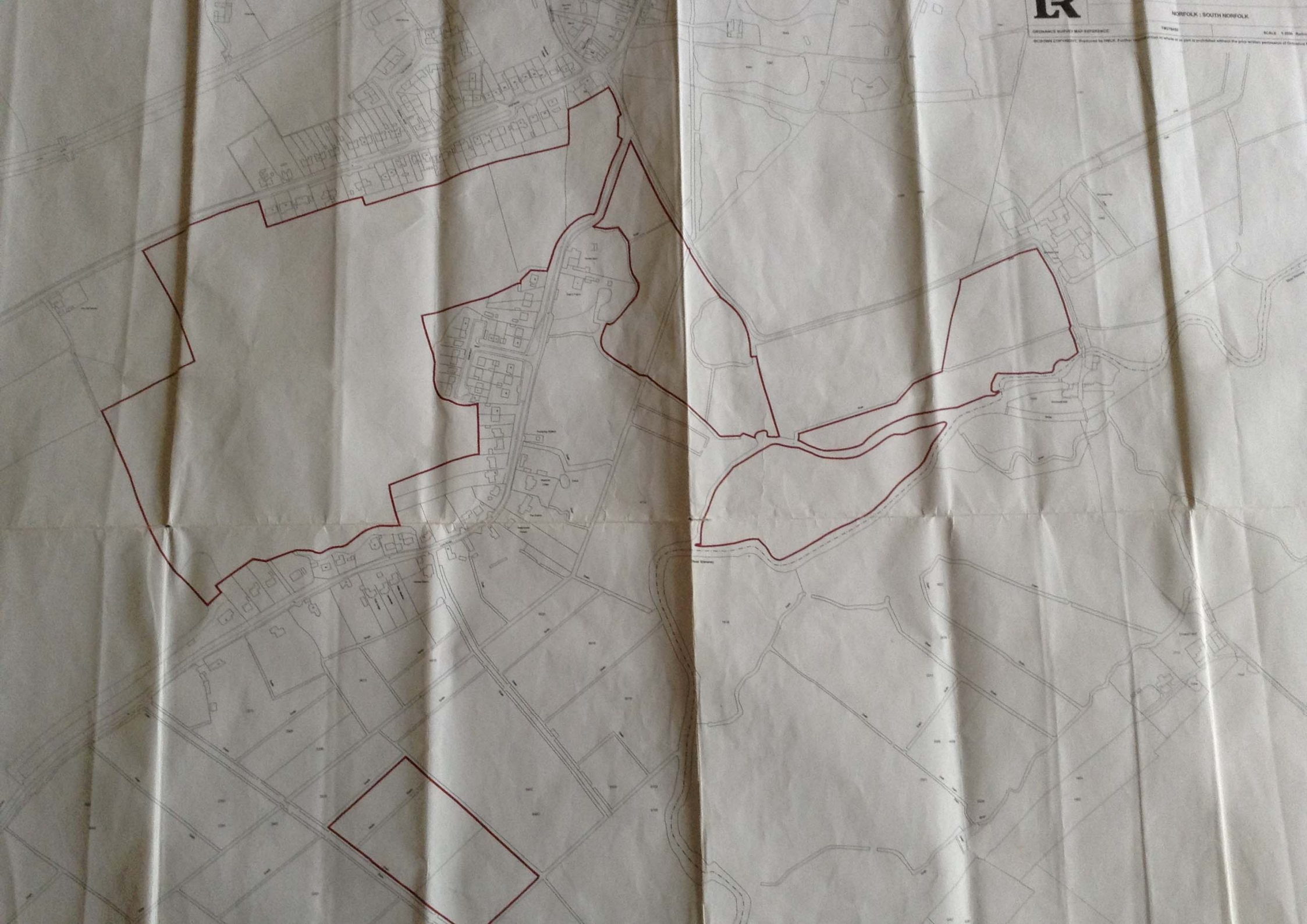

Greater Norwich Call for Sites Submission Form

FOR OFFICIAL USE ONLY	
Response Number:	GNLP0056
Date Received:	

This form is to be filled out by any interested parties who want to promote a site for a specific use or development to be allocated in the Greater Norwich Local Plan.

Only one form should be submitted for each individual site i.e. it is not necessary for a separate form to be completed for each landowner on a single site in multiple ownerships. However, a separate form must be completed for each individual site submitted.

Your completed form should be returned to the Greater Norwich Local Plan team no later than **5pm on Friday 24 June 2016**.

By email: callforsites@gnlp.org.uk

Or, if it is not possible submit the form electronically,

By Post to:

*Greater Norwich Local Plan Team
PO Box 3466
Norwich
NR7 7NX*

The responses received as part of the Greater Norwich Local Plan Call for Sites will be published and made available for public viewing. By submitting this form you are consenting to the details about you and your individual site(s) being stored by Norfolk County Council and shared with Broadland District Council, Norwich City Council and South Norfolk District Council, and that the details of the site will be published for consultation purposes.

Further advice and guidance can be obtained by visiting the Greater Norwich Local Plan website or by contacting the Greater Norwich Local Plan team directly:

Website: www.greaternorwichlocalplan.org.uk

E-mail: callforsites@gnlp.org.uk

Telephone: 01603 306603

1a. Contact Details	
Title	Mr
First Name	Mark
Last Name	Philpot
Job Title (where relevant)	
Organisation (where relevant)	
Address	One Planning (Unit 3) 83-87 Pottergate NULL Norwich Norfolk
Post Code	NR2 1DZ
Telephone Number	01603 518 333 NULL
Email Address	info@oneplanning.co.uk

1b. I am...
Planning Consultant

1c. Client/Landowner Details (if different from question 1a)	
Title	
First Name	
Last Name	
Job Title (where relevant)	
Organisation (where relevant)	
Address	
Telephone Number	
Email Address	

2. Site Details	
Site location / address and post code (please include as an attachment to this response form a location plan of the site on an scaled OS base with the boundaries of the site clearly shown)	Land at Bell Meadow, Low Road NULL Wortwell Harleston Norfolk
Grid reference (if known)	TM275846

Site area (hectares)	0.8
Site parish	Wortwell
Site district	South Norfolk

Site Ownership	
3a. I (or my client)...	
Is the sole owner of the site	
3b. Please provide the name, address and contact details of the site's landowner(s) and attach copies of all relevant title plans and deeds (if available).	
3c. If the site is in multiple landownerships do all landowners support your proposal for the site?	NULL
3d. If you answered no to the above question please provide details of why not all of the sites owners support your proposals for the site.	

Current and Historic Land Uses
4a. Current Land Use (Please describe the site's current land use e.g. agriculture, employment, unused/vacant etc.)

Agricultural	
4b. Has the site been previously developed?	No
4c. Describe any previous uses of the site. (please provide details of any relevant historic planning applications, including application numbers if known)	
NULL	

Proposed Future Uses	
5a. Please provide a short description of the development or land use you proposed (if you are proposing a site to be designated as local green space please go directly to question 6)	
Housing	
5b. Which of the following use or uses are you proposing?	
Market Housing	Yes
Affordable Housing	No
Residential Care Home	No
Gypsy and Traveller Pitches	No
Business and offices	No
General industrial	No
Storage and distribution	No
Tourism	No
Recreation & Leisure	No
Community Use	No
Public Open Space	No
Other (Please Specify)	NULL
5c. Please provide further details of your proposal, including details on number of houses and proposed floorspace of commercial buildings etc.	

Between 6-10 units

5d. Please describe any benefits to the Local Area that the development of the site could provide.

New housing and associated economic, social and environmental benefits both short and long term.

Local Green Space

If you are proposed a site to be designated as Local Green Space please complete the following questions. These questions do not need to be completed if you are not proposing a site as Local Green Space. Please consult the guidance notes for an explanation of Local Green Space Designations.

6a. Are you proposing a site to be designated as a Local Green Space?

No

6b. Which community would the site serve and how would the designation of the site benefit that community.

NULL

6c. Please describe why you consider the site to be of particular local significance e.g. recreational value, tranquillity or richness in wildlife.

NULL

Site Features and Constraints

Are there any features of the site or limitations that may constrain development on this site (please give details)?

7a. Site Access: Is there a current means of access to the site from the public highway, does this access need to be improved before development can take place and are there any public rights of way that cross or adjoin the site?

No. A new vehicular access would need to be provided. There are no Public Rights of Way that cross or adjoin the site.

7b. Topography: Are there any slopes or significant changes of in levels that could affect the development of the site?
None.
7c. Ground Conditions: Are ground conditions on the site stable? Are there potential ground contamination issues?
Yes, site conditions are stable. There are no land contamination issues. From our knowledge of the site we can confirm:- i) There are no above or below ground fuel storage tanks ii) No high-voltage overhead lines iii) No die back vegetation iv) No war
7d. Flood Risk: Is the site liable to river, ground water or surface water flooding and if so what is the nature, source and frequency of the flooding?
The site is not liable for flooding and has no historical flooding issues.
7e. Legal Issues: Is there land in third party ownership, or access rights, which must be acquired to develop the site, do any restrictive covenants exist, are there any existing tenancies?
No third party ownership or access rights to the site. No covenants are on the land. The site is under a 3 generation tenancy although this permits the release and sale of land including the proposed site.
7f. Environmental Issues: Is the site located next to a watercourse or mature woodland, are there any significant trees or hedgerows crossing or bordering the site are there any known features of ecological or geological importance on or adjacent to the site?
No.
7g. Heritage Issues: Are there any listed buildings, Conservation Areas, Historic Parklands or Schedules Monuments on the site or nearby? If so, how might the site's development affect them?
No.
7h. Neighbouring Uses: What are the neighbouring uses and will either the proposed use or neighbouring uses have any implications?
Public House to the north. Agricultural land to the east and west. Residential use to the north west and south. No implications would arise.

7i. Existing uses and Buildings: are there any existing buildings or uses that need to be relocated before the site can be developed.

No.

7j. Other: (please specify):

None.

Utilities

8a. Which of the following are likely to be readily available to service the site and enable its development? Please provide details where possible.

Mains water supply	Yes
Mains sewerage	Yes
Electricity supply	Yes
Gas supply	Unsure
Public highway	Yes
Broadband internet	Yes
Other (please specify):	NULL

8b. Please provide any further information on the utilities available on the site:

All mains services run along Low Road.

Availability

9a. Please indicate when the site could be made available for the land use or development proposed.

Immediately

9b. Please give reasons for the answer given above.

The land is owned solely by Mr and Mrs Riches and is available immediately.

Market Interest

10. Please indicate what level of market interest there is/has been in the site. Please include relevant dates in the comments section.

Not known

Comments

The site has not been actively marketed to date.

Delivery

11a. Please indicate when you anticipate the proposed development could be begun.

Immediately

11b. Once started, how many years do you think it would take to complete the proposed development (if known)?

1 year.

Viability

12a. You acknowledge that there are likely to be policy requirements and Community Infrastructure Levy (CIL) costs to be met which will be in addition to the other development costs of the site (depending on the type and scale of land use proposed). These requirements are likely to include but are not limited to: Affordable Housing; Sports Pitches & Children's Play Space and Community Infrastructure Levy

Yes

12b. Do you know if there are there any abnormal costs that could affect the viability of the site e.g. infrastructure, demolition or ground conditions?

No

12c. If there are abnormal costs associated with the site please provide details:

NULL

12d. Do you consider that the site is currently viable for its proposed use taking into account any and all current planning policy and CIL considerations and other abnormal development costs associated with the site?

Yes

12e. Please attach any viability assessment or development appraisal you have undertaken for the site, or any other evidence you consider helps demonstrate the viability of the site.

The applicant has considered the viability of a development of 6 houses/bungalows to incorporate two affordable housing units and found that there is an acceptable positive site value at a 20% developers return. If further units were to be constructed on the site then this would make the development more rather than less viable.

Other Relevant Information

13. Please use the space below to for additional information or further explanations on any of the topics covered in this form

Nothing.

Check List	
Your Details	
Site Details (including site location plan)	
Site Ownership	
Current and Historic Land Uses	
Proposed Future Uses	
Local Green Space (Only to be completed for proposed Local Green Space Designations)	
Site Features and Constraints	
Utilities	
Availability	
Market Interest	
Delivery	
Viability	
Other Relevant Information	
Declaration	

14. Declaration
<p>I understand that:</p> <p>Data Protection and Freedom of Information The Data Controller of this information under the Data Protection Act 1998 will be Norfolk County Council, which will hold the data on behalf of Broadland District Council, Norwich City Council and South Norfolk District Council. The purposes of collecting this data are:</p> <ul style="list-style-type: none"> • to assist in the preparation of the Greater Norwich Local Plan • to contact you, if necessary, regarding the answers given in your form • to evaluate the development potential of the submitted site for the uses proposed within the form <p>Disclaimer The responses received as part of the Greater Norwich Local Plan "Call for Sites" will be published and made available for public viewing. By submitting this form you are consenting to the details about you and your individual sites being stored by Norfolk County Council, and the details being published for consultation purposes. Any information you consider to be confidential is clearly marked in the submitted response form and you have confirmed with the Council(s) in advance that such information can be kept confidential as instructed in the Greater Norwich Local Plan Call for Sites Response Form Guidance Notes.</p> <p>I agree that the details within this form can be held by Norfolk County Council and that those details can be shared with Broadland District Council, Norwich City Council and South Norfolk District Council for the purposes specified in this declaration.</p>

Name Mark Philpot	Date 6/2/2016
----------------------	------------------