

SITE LOCATION PLAN 1 / 1250

PETER CODLING ARCHITECTS

7 THE OLD CHURCH, ST. MATTHEW'S ROAD, NORWICH, NR1 1SP Tel: 01603 660408
Fax: 01603 630339

**SITE AT FRENZE HALL LANE
DISS**

MR C BURNARD

SCALE 1 / 1250

JOB NO 5443	20
-------------	----

DATE JUNE 2016 DRAWN BY

THIS DESIGN IS THE COPYRIGHT OF PETER CODLING ARCHITECTS AND MAY NOT BE ALTERED, PHOTOGRAPHED, COPIED OR REPRODUCED WITHOUT WRITTEN CONSENT.

ALL DIMENSIONS ARE TO BE CHECKED BY THE GENERAL CONTRACTOR ON SITE AND ANY DISCREPANCY CLARIFIED BY THE ARCHITECT BEFORE THE WORK PROCEEDS.

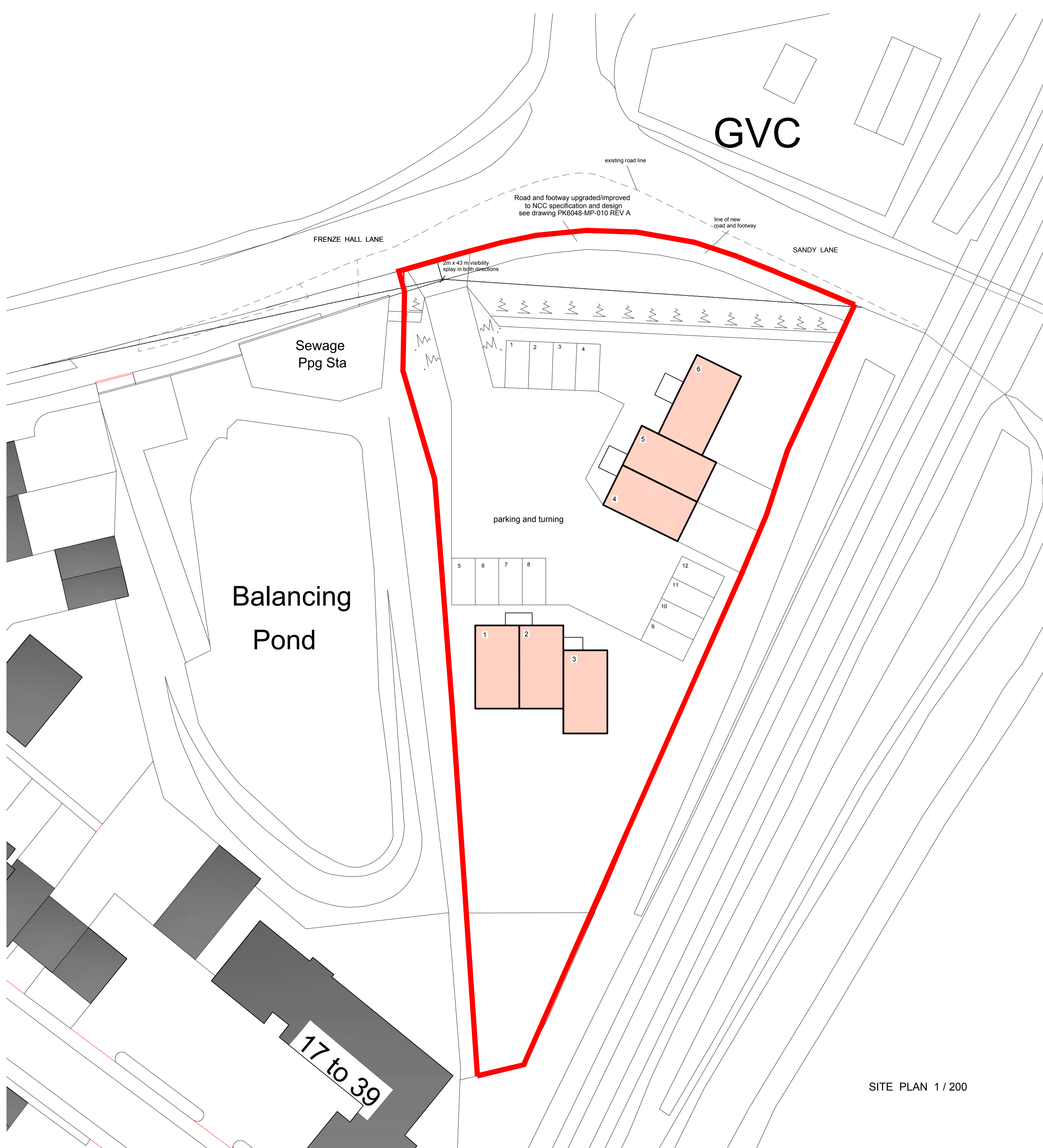

SITE PLAN 1 / 200

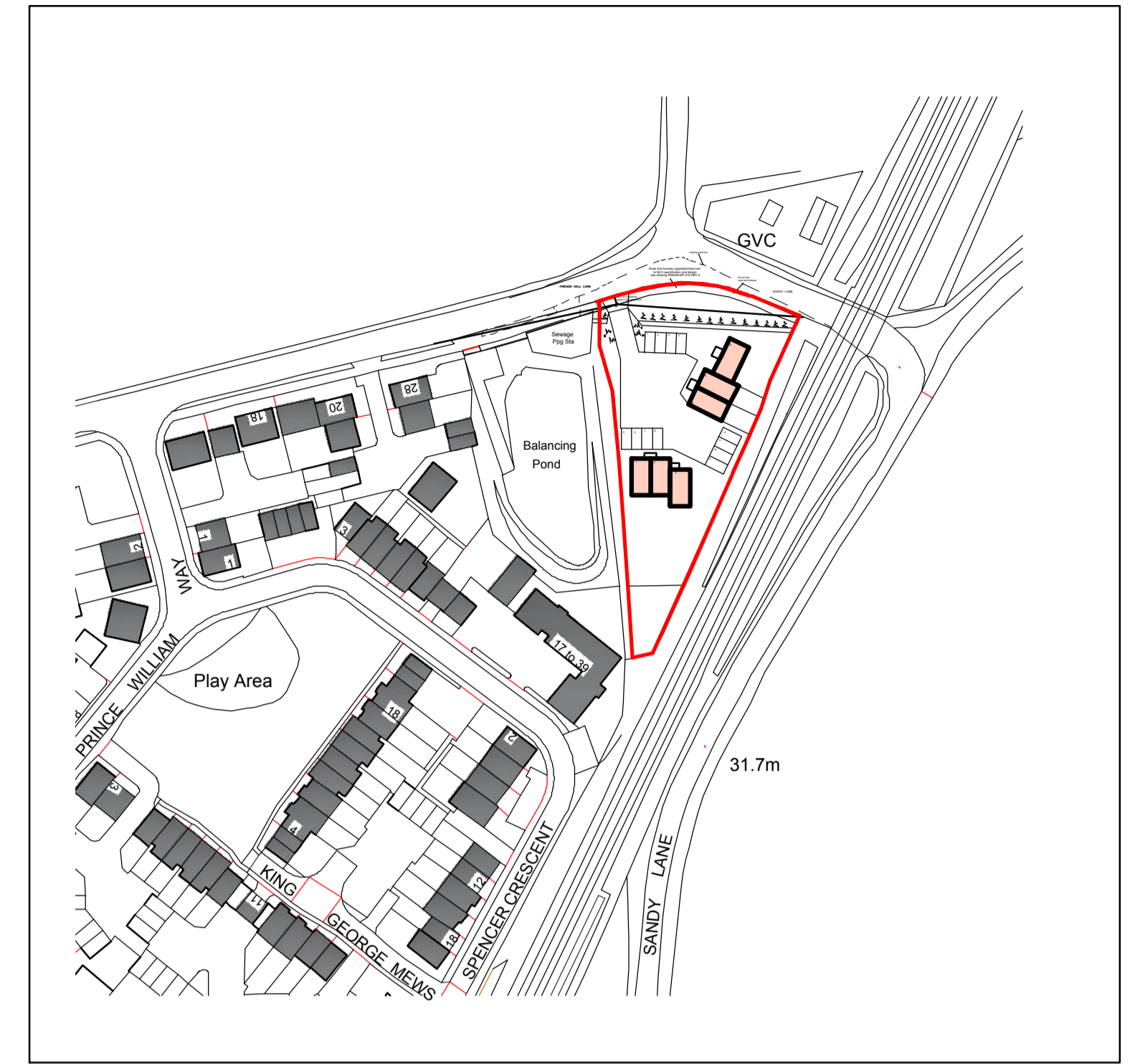

SITE LOCATION PLAN 1 / 1250

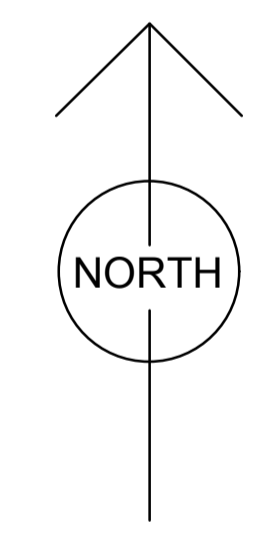

PETER CODLING ARCHITECTS
 7 THE OLD CHURCH, ST. MATTHEWS ROAD, NORWICH, NR1 1SP Tel: 01603 660408
 Fax: 01603 630339

SITE AT FRENZE HALL LANE DISS
 MR C BURNARD

INDICATIVE SITE PLAN

SCALE	1/100	
JOB NO	5443	21
DATE	DRAWN BY	

THIS DESIGN IS THE COPYRIGHT OF PETER CODLING ARCHITECTS AND MAY NOT BE ALTERED, PHOTOGRAPHED, COPIED OR REPRODUCED WITHOUT WRITTEN CONSENT.
 ALL DIMENSIONS ARE TO BE CHECKED BY THE GENERAL CONTRACTOR ON SITE AND ANY DISCREPANCY CLARIFIED BY THE ARCHITECT BEFORE THE WORK PROCEEDS.

KEY:

- Proposed re-alignment / resurfacing of carriageway
- Proposed haunch widening of carriageway
- Proposed new footway
- Proposed new verge
- Proposed new bank
- Proposed new kerbs / edgings
- Proposed new gullies
- Existing kerbs

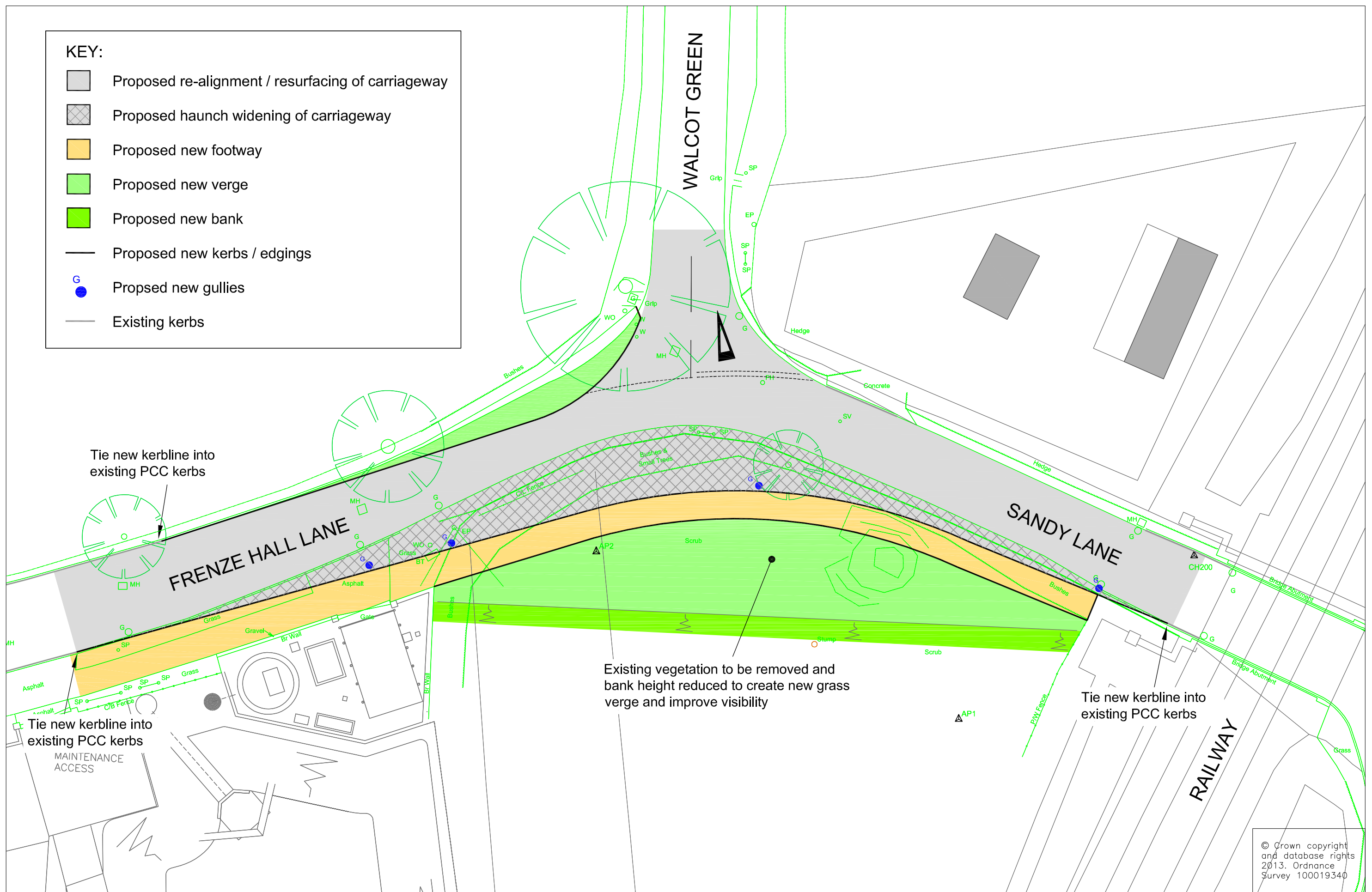

© Crown copyright and database rights 2013. Ordnance Survey 100019340

REV.	DESCRIPTION	CHECKED	DATE
A	Haunch area added	NRW	06/13

SURVEYED BY	INITIALS	DATE	DRAWING No.
	PS	2012	PK6048-MP-010 Rev A
DESIGNED BY	DAG	02/13	PROJECT TITLE
DRAWN BY	DAG	02/13	Djss Frenze Hall Lane S106 Improvements
CHECKED BY	PSM	02/13	SCALE 1:250
			FILE No. PK6048

Greater Norwich Call for Sites Submission Form

FOR OFFICIAL USE ONLY	
Response Number:	GNLP0112
Date Received:	

This form is to be filled out by any interested parties who want to promote a site for a specific use or development to be allocated in the Greater Norwich Local Plan.

Only one form should be submitted for each individual site i.e. it is not necessary for a separate form to be completed for each landowner on a single site in multiple ownerships. However, a separate form must be completed for each individual site submitted.

Your completed form should be returned to the Greater Norwich Local Plan team no later than **5pm on Friday 24 June 2016**.

By email: callforsites@gnlp.org.uk

Or, if it is not possible submit the form electronically,

By Post to:

*Greater Norwich Local Plan Team
PO Box 3466
Norwich
NR7 7NX*

The responses received as part of the Greater Norwich Local Plan Call for Sites will be published and made available for public viewing. By submitting this form you are consenting to the details about you and your individual site(s) being stored by Norfolk County Council and shared with Broadland District Council, Norwich City Council and South Norfolk District Council, and that the details of the site will be published for consultation purposes.

Further advice and guidance can be obtained by visiting the Greater Norwich Local Plan website or by contacting the Greater Norwich Local Plan team directly:

Website: www.greaternorwichlocalplan.org.uk

E-mail: callforsites@gnlp.org.uk

Telephone: 01603 306603

1a. Contact Details	
Title	Mr
First Name	Martin
Last Name	Howe
Job Title (where relevant)	
Organisation (where relevant)	
Address	Peter Codling Architects 7 The Old Church St Matthews Road Norwich Norfolk
Post Code	NR1 1SP
Telephone Number	01603 660408 NULL
Email Address	martin@petercodlingarchitects.co.uk

1b. I am...
Planning Consultant

1c. Client/Landowner Details (if different from question 1a)	
Title	
First Name	
Last Name	
Job Title (where relevant)	
Organisation (where relevant)	
Address	
Telephone Number	
Email Address	

2. Site Details	
Site location / address and post code (please include as an attachment to this response form a location plan of the site on an scaled OS base with the boundaries of the site clearly shown)	Land at Frenze Hall Lane NULL NULL Diss Norfolk
Grid reference (if known)	TM129802

Site area (hectares)	0.218
Site parish	Diss
Site district	South Norfolk

Site Ownership	
3a. I (or my client)...	
Is the sole owner of the site	
3b. Please provide the name, address and contact details of the site's landowner(s) and attach copies of all relevant title plans and deeds (if available).	
3c. If the site is in multiple landownerships do all landowners support your proposal for the site?	NULL
3d. If you answered no to the above question please provide details of why not all of the sites owners support your proposals for the site.	

Current and Historic Land Uses
4a. Current Land Use (Please describe the site's current land use e.g. agriculture, employment, unused/vacant etc.)

Underused scrubland/meadowland

4b. Has the site been previously developed?

No

4c. Describe any previous uses of the site. (please provide details of any relevant historic planning applications, including application numbers if known)

Underused scrubland/meadowland

Proposed Future Uses

5a. Please provide a short description of the development or land use you proposed (if you are proposing a site to be designated as local green space please go directly to question 6)

Residential development

5b. Which of the following use or uses are you proposing?

Market Housing	Yes
Affordable Housing	No
Residential Care Home	No
Gypsy and Traveller Pitches	No
Business and offices	No
General industrial	No
Storage and distribution	No
Tourism	No
Recreation & Leisure	No
Community Use	No
Public Open Space	No
Other (Please Specify)	NULL

5c. Please provide further details of your proposal, including details on number of houses and proposed floorspace of commercial buildings etc.

Land suitable for between 4- 8 dwellings. Road improvements by County Council highways agreement in place to improve and upgrade corner by taking land from owner to achieve . see separate drawing. Indicative drawing of possible layout included in attachments.

5d. Please describe any benefits to the Local Area that the development of the site could provide.

Additional much needed housing in a sustainable location with footpath links into the centre of Diss. Roadwork improvements to the existing corner as shown on enclosed drawing to improve highway safety.

Local Green Space

If you are proposing a site to be designated as Local Green Space please complete the following questions. These questions do not need to be completed if you are not proposing a site as Local Green Space. Please consult the guidance notes for an explanation of Local Green Space Designations.

6a. Are you proposing a site to be designated as a Local Green Space?

No

6b. Which community would the site serve and how would the designation of the site benefit that community.

NULL

6c. Please describe why you consider the site to be of particular local significance e.g. recreational value, tranquillity or richness in wildlife.

NULL

Site Features and Constraints

Are there any features of the site or limitations that may constrain development on this site (please give details)?

7a. Site Access: Is there a current means of access to the site from the public highway, does this access need to be improved before development can take place and are there any public rights of way that cross or adjoin the site?

No access at present. see drawing showing new access and visibility splays there are no public rights of way

7b. Topography: Are there any slopes or significant changes of in levels that could affect the development of the site?
No existing building this is a clear and level site. Some trees around perimeter of site. The owner is having an arboricultural report carried out
7c. Ground Conditions: Are ground conditions on the site stable? Are there potential ground contamination issues?
Due to historic land use it is unlikely that contamination will be a concern. The site adjoining is now fully developed for residential purposes. see drawing
7d. Flood Risk: Is the site liable to river, ground water or surface water flooding and if so what is the nature, source and frequency of the flooding?
The site lies outside Environment Agency flood zones
7e. Legal Issues: Is there land in third party ownership, or access rights, which must be acquired to develop the site, do any restrictive covenants exist, are there any existing tenancies?
No third party owners . there is an agreement for the highway improvements with the owner of the site to be carried out.
7f. Environmental Issues: Is the site located next to a watercourse or mature woodland, are there any significant trees or hedgerows crossing or bordering the site are there any known features of ecological or geological importance on or adjacent to the site?
No
7g. Heritage Issues: Are there any listed buildings, Conservation Areas, Historic Parklands or Schedules Monuments on the site or nearby? If so, how might the site's development affect them?
No
7h. Neighbouring Uses: What are the neighbouring uses and will either the proposed use or neighbouring uses have any implications?
Railway line to the East. Residential housing estate to the West. See layout plans
7i. Existing uses and Buildings: are there any existing buildings or uses that need to be relocated before the site can be developed.
No
7j. Other: (please specify):

Road improvements to be carried out to incorporate access to the site. Agreement with owner already in place for the improvements to the corner

Utilities

8a. Which of the following are likely to be readily available to service the site and enable its development? Please provide details where possible.

Mains water supply	Yes
Mains sewerage	Yes
Electricity supply	Yes
Gas supply	Yes
Public highway	Yes
Broadband internet	Yes
Other (please specify):	NULL

8b. Please provide any further information on the utilities available on the site:

Foul water sewer available in road close to the site. It is understood that all other services are located in the road and available for connection.

Availability

9a. Please indicate when the site could be made available for the land use or development proposed.

Immediately

9b. Please give reasons for the answer given above.

The site would be available immediately for commencement subject to the corner highway improvements being carried out

Market Interest	
10. Please indicate what level of market interest there is/has been in the site. Please include relevant dates in the comments section.	
Site is owned by a developer/promoter	
Comments	NA

Delivery	
11a. Please indicate when you anticipate the proposed development could be begun.	
Immediately	
11b. Once started, how many years do you think it would take to complete the proposed development (if known)?	
1 - 2 years	

Viability	
12a. You acknowledge that there are likely to be policy requirements and Community Infrastructure Levy (CIL) costs to be met which will be in addition to the other development costs of the site (depending on the type and scale of land use proposed). These requirements are likely to include but are not limited to: Affordable Housing; Sports Pitches & Children's Play Space and Community Infrastructure Levy	Yes
12b. Do you know if there are there any abnormal costs that could affect the viability of the site e.g. infrastructure, demolition or ground conditions?	No
12c. If there are abnormal costs associated with the site please provide details: NULL	
12d. Do you consider that the site is currently viable for its proposed use taking into account any and all current planning policy and CIL considerations and other abnormal	Yes

development costs associated with the site?	
---	--

12e. Please attach any viability assessment or development appraisal you have undertaken for the site, or any other evidence you consider helps demonstrate the viability of the site.

The site is in one ownership and does not rely on third parties for the development to proceed. There is already an agreement with the owner for the highway improvements to the corner to be carried out which would be of benefit to Diss and the existing highway network. The site is in a sustainable location. This site would be both viable and deliverable.

Other Relevant Information

13. Please use the space below to for additional information or further explanations on any of the topics covered in this form

see enclosed drawings
5443 20
5443 21
highway improvement plan

Check List

Your Details	
Site Details (including site location plan)	
Site Ownership	
Current and Historic Land Uses	
Proposed Future Uses	
Local Green Space (Only to be completed for proposed Local Green Space Designations)	
Site Features and Constraints	
Utilities	
Availability	
Market Interest	
Delivery	
Viability	
Other Relevant Information	
Declaration	

14. Declaration	
I understand that:	
<p>Data Protection and Freedom of Information</p> <p>The Data Controller of this information under the Data Protection Act 1998 will be Norfolk County Council, which will hold the data on behalf of Broadland District Council, Norwich City Council and South Norfolk District Council. The purposes of collecting this data are:</p> <ul style="list-style-type: none"> • to assist in the preparation of the Greater Norwich Local Plan • to contact you, if necessary, regarding the answers given in your form • to evaluate the development potential of the submitted site for the uses proposed within the form 	
<p>Disclaimer</p> <p>The responses received as part of the Greater Norwich Local Plan "Call for Sites" will be published and made available for public viewing. By submitting this form you are consenting to the details about you and your individual sites being stored by Norfolk County Council, and the details being published for consultation purposes. Any information you consider to be confidential is clearly marked in the submitted response form and you have confirmed with the Council(s) in advance that such information can be kept confidential as instructed in the Greater Norwich Local Plan Call for Sites Response Form Guidance Notes.</p>	
I agree that the details within this form can be held by Norfolk County Council and that those details can be shared with Broadland District Council, Norwich City Council and South Norfolk District Council for the purposes specified in this declaration.	
Name Martin Howe	Date 6/22/2016