

OAS 17-073-TS04

OAS 17-073-TS05

G8







W3

W3

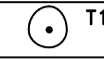
OAS 17-073-TS05

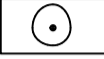
OAS 17-073-TS06

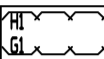
KEY

-  Existing Tree colour referenced in accordance with BS 5837 2005.
-  Green - Cat A Trees of high quality and value
-  Blue - Cat B Trees of moderate quality and value
-  Grey - Cat C Trees of low quality and value
-  Red - Cat R Trees that are dead or showing signs of irreversible decline
-  Existing hedge or group, colour coded as above in accordance with BS 5837.
-  Root Protection Area as calculated in accordance with BS 5837 2005
-  Indicative shade pattern as to BS 5837



REV.	DATE	INITIALS	DETAILS

CLIENT Persimmon, Taylor Wimpey, Hogkine Homes		DWG. TITLE Tree Constraints Plan (5 of 7)	
SITE: Land at Sprowston			
DRAWN BY SPM	CHECKED BY SPM	SCALE 1:500 MA1	DATE July 2017
DWG NO. OAS 17-073-TS05		REV. 	

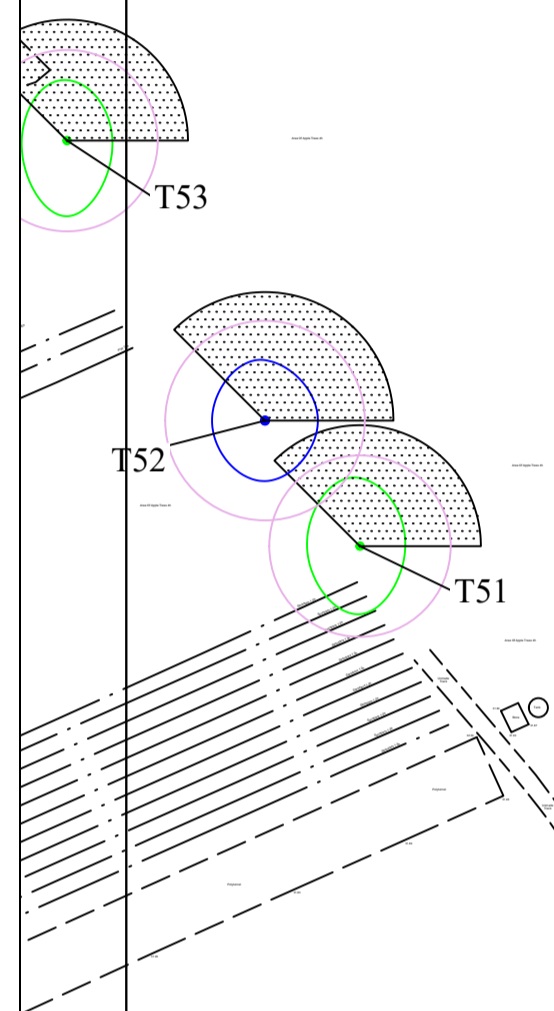

S-TS01