

Note: The Property of This Drawing is Vested in BB SURVEYS LTD And Must Not Be Copied Or Reproduced In Any Way Without Their Written Consent
 File Path: C:\Work\Scott Properties\2219-413 - Scott Properties - Land at Marriots Way, Taverham.swg
 Plot Date: 21 February 2017 Plot Style: BB Surveys Std.ctb Saved By: Administrator on 21 February 2017

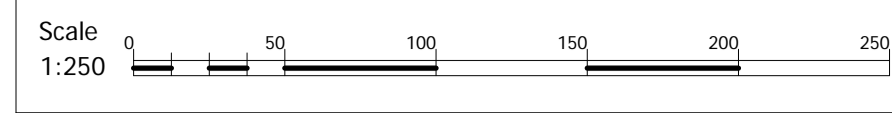
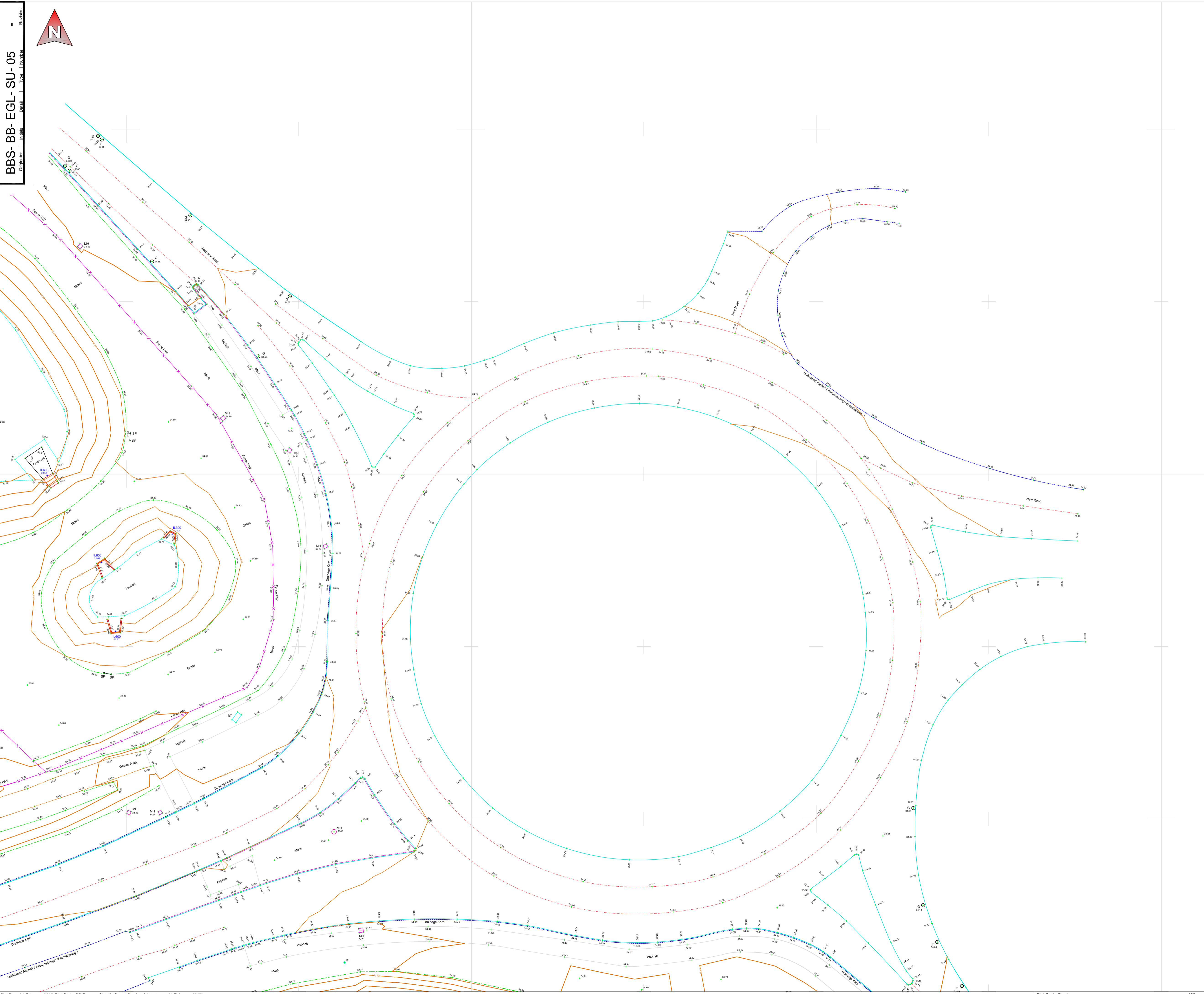

Notes:

AV Air Valve	FH Fire Hydrant	SP Sign Post
BB Bottom Bank	FP Footpath	STAY Stay
BH Bore Hole	GV Gully Grate	SV Sluice Valve
BL Lt Bollard	IC Inspection Cover	TAC Tactile Paving
BOL Bollard	IL Invert Level	TB Top Bank
BIN Bin	KO Kerb Outlet	TBOX Telephone Box
BS Bus Stop	LP Lamp Post	TL Traffic Light
Bushes Bush	MH Manhole	TOK Top Of Kerb
BT BT Box	MP Marker Post	TP Telegraph Pole
CAB Cabinet	NB Name Board	TRK Track
CHNL Channel	PW Partition Wall	TS Traffic Sign MH
CL Centreline	PB Post Box	VENT Vent
CONC Concrete	PM Parking Meter	W Water Cover
COL Column	PO Post	WL White Line
DB Drop Bottom	RE Rodding Eye	WO Wash Out
DCHNL Drainage Channel	RF Ridge Level	YL Yellow Line
Door Door	RP Reflector Post	
EEB Electric MH Cover	RS Road Sign	
EP Electric Pole	SETTS Granite Sets	
ER Earth Road	SF Safety Fence	
ET EP+Transformer		
Feeder Feeder Pillar		

Features

Fences	FCB 1.8m	Control Station
Walls	WAL 1.2m	Column
Hedges	Hedge 1.2m	XXX Floor to Ceiling Height
Overhead Line	OHL	XXX 6.0 Floor to False Ceiling Height

Services

Foul Sewers	0.225m	FW 100	Pipe position and alignment is indicative only.
Storm Sewers	0.375m	SW 150	

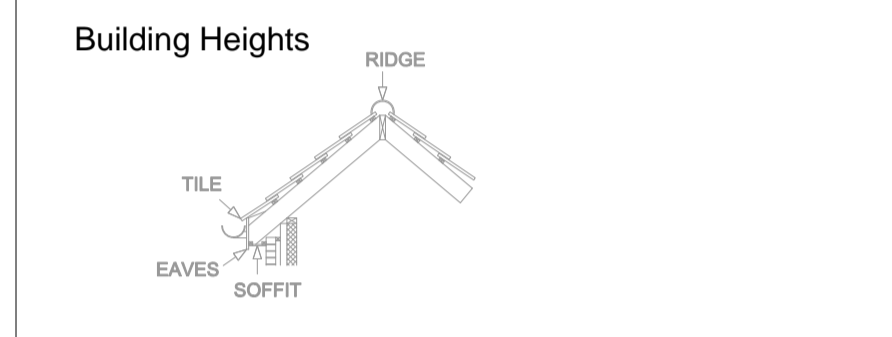

SURVEY CARRIED OUT USING TRIMBLE S8 TOTAL STATION & TRIMBLE R10 GPS. ALL SURVEY DATA TO ORDNANCE SURVEY NATIONAL GRID (OSN2115). ALL DIMENSIONS ARE IN METRES UNLESS OTHERWISE STATED. ANY CRITICAL DIMENSIONS AND MEASUREMENTS SHOULD BE BASED ON THE ORIGINAL DIGITAL DATA AND CONFIRMED WITH BB SURVEYS LTD. ANY ERRORS SHOULD BE NOTIFIED TO BB SURVEYS LTD.

NO ATTEMPT HAS BEEN MADE TO ENTER ANY CONFINED SPACES ON THIS SITE. WE HAVE MEASURED INVERT DEPTHS, ESTIMATED PIPE SIZES AND SHOWN THE DIRECTION OF FLOW ONLY WHERE DRAIN RUNS ARE ACTIVE AT THE TIME OF SURVEY. INSPECTION COVERS WHICH WE WERE UNABLE TO LIFT BY MANUAL METHODS ARE DENOTED AS MH (D/L). WE DO NOT QUOTE FOR THE USE OF HYDRAULIC LIFTING EQUIPMENT.

DRAINAGE RUNS BETWEEN INSPECTION COVERS HAVE NOT BEEN INVESTIGATED. ANY SHOWN ARE ESTIMATED AND NOT CONFIRMED. ALL DRAINAGE RUNS SHOULD BE PROBED BY DYE TRACING AND, IF NECESSARY BY RADIO DETECTION METHODS PRIOR TO ANY DESIGN WORK. ALL PIPE SIZES AND CONNECTIONS SHOULD ALSO BE CONFIRMED WITH YOUR LOCAL DRAINAGE AUTHORITY PRIOR TO ANY DESIGN WORK.

THERE MAY BE INSPECTION COVERS ON SITE WHICH WERE NOT VISIBLE AT THE TIME OF SURVEY. THEY MAY HAVE BEEN BURIED OR COVERED BY VEGETATION. YOU SHOULD CONSULT YOUR LOCAL DRAINAGE AUTHORITY OR COMMISSION A CCTV DRAINAGE SURVEY TO ENSURE THAT YOU LOCATE ANY MISSING COVERS OR DRAINAGE RUNS.

REV	Date	Created By	Comments
-	14.02.17	BB	First Issue

Scale at A1	1:250
Project Number	2219-413



**1 Chestnut Place, Cringleford
 Norwich, Norfolk NR4 7BD**
 t: 01603 507917
 m: 07786 388175
 e: barry@bbsurveys.co.uk

Client
**Scott Properties
 Graham McCormick**

Project
**Land at Marriots Way,
 Taverham, Norwich**

Title
**Existing Ground Level Survey
 Sheet 4**